

ARCHITECTURAL/HISTORIC INVENTORY FORM

1. Survey No. ADAS002-0009		2. Survey name: Kirkville Historic Properties Survey	
3. County: Adair		4. Address: 201 N. Centennial	
5. City: Kirkville	Vicinity: <input type="checkbox"/>	6. UTM: 15/534993/4449547	7. Township/Range/Section: T: 62 R: 15 S: 9
8. Historic name (if known): Kirkville Cemetery		9. Present/other name (if known): Forest-Llewellyn Cemetery	
10. Ownership: <input type="checkbox"/> Private <input checked="" type="checkbox"/> Public		11. Historic use (if known): Cemetery	11. Current use: Cemetery

ARCHITECTURAL INFORMATION

12. Category of property: <input type="checkbox"/> building(s) <input checked="" type="checkbox"/> site <input type="checkbox"/> structure <input type="checkbox"/> object	19. Chimney placement:	26. Changes (describe in box 28 cont.): <input type="checkbox"/> Addition(s) Date(s): <input type="checkbox"/> Altered Date(s): <input type="checkbox"/> Moved Date(s): <input type="checkbox"/> Other Date(s): Endangered by:
13. Architectural style or vernacular type:	20. Structural system:	
14. Plan shape:	21. Ext. wall cladding:	
15. No. of stories:	22. Foundation material:	27. Outbuildings (describe in box 27 cont.): The only structure on the site is the Baird family mausoleum on the south side of the cemetery entrance.
16. No. of bays (1 st floor):	23. Basement type:	
17. Roof type:	24. Front porch type:	
18. Roof material:	25. Acreage (rural): Visible from public road? <input type="checkbox"/>	28. Further description of building features and associated resources on continuation page. <input type="checkbox"/>

HISTORICAL DATA

29. Construction date: c. 1845	32. Architect:	35. Previously surveyed? <input type="checkbox"/> Survey name:
30. Significant date/period: First Burial in 1845	33. Builder/contractor:	36. On National Register? <input type="checkbox"/> indiv. <input type="checkbox"/> district Nomination:
31. Area(s) of significance: Mass Grave of Confederate Soldiers	34. Original or significant owner:	37. National Register eligible? <input type="checkbox"/> individually eligible <input type="checkbox"/> district potential
38. History and significance on continuation page. <input checked="" type="checkbox"/>		39. Sources of information on continuation page. <input checked="" type="checkbox"/>

OTHER

40. Current owner/address: City of Kirkville 201 S. Franklin St. Kirkville, Missouri 63501	41. Form prepared by (name and org.): Brad Selby Kirkville Historic Preservation Comm. City of Kirkville	42. Survey date: March, 2009
		43. Date of revisions:

FOR SHPO USE:

Date entered in inventory:	Level of survey <input type="checkbox"/> reconnaissance <input type="checkbox"/> intensive	Additional research needed? <input type="checkbox"/> yes <input type="checkbox"/> no
National Register Status: <input type="checkbox"/> listed <input type="checkbox"/> in listed district Name: <input type="checkbox"/> pending listing <input type="checkbox"/> eligible (individually) <input type="checkbox"/> eligible (district) <input type="checkbox"/> not eligible <input type="checkbox"/> not determined	Other:	



ARCHITECTURAL/HISTORIC INVENTORY FORM

Location Map (include north arrow):



Site Map/plan (include north arrow):

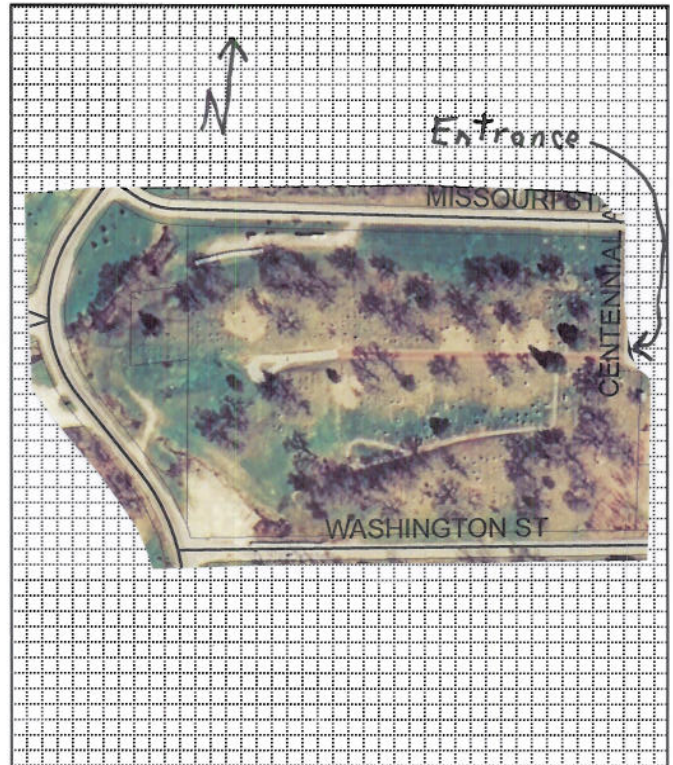

ADDITIONAL INFORMATION:

27. (cont.) Description of environment and outbuildings. Expand box as necessary, or add continuation pages.

28. (cont.) Further description of important architectural features. Expand box as necessary, or add continuation pages.
No structures other than Baird vault.

38. (cont.) History and significance. Expand box as necessary, or add continuation pages.

Much of the information below is reprinted from "Rich in Kirksville History" by Mrs. Elizabeth Laughlin, as appeared in the second printing of the Forest-Llewellyn Cemetery Records:

The Forest-Llewellyn Cemetery, originally known as the "Kirksville Cemetery," is the oldest cemetery for public use in Kirksville. The Cemetery marks a site rich in history and importance to the Kirksville community. The original sextons of the Cemetery were A.R. Morgan, H. Holcroft, J.F. Stinks, Sam Morgan, Mr. Boyd, Charles Douglas, and Cling Myers.

The first man to be buried in the Forest-Llewellyn Cemetery was a traveler who died visiting Kirksville in 1845. One year later, on August 31, 1846, Jesse Kirk, the man for whom Kirksville was named, became the first actual Kirksville resident to be buried in the Cemetery. Following this burial the Forest-Llewellyn Cemetery became a public burial ground.

Andrew Taylor Still, the Founder of Osteopathic medicine, is also buried here in the cemetery, as well as several members of his family.

Many additions have expanded the Cemetery through the years. Judge Slingerland laid off an addition to the Cemetery in 1878 followed by Judge Jacob Sands who laid off another addition. Over time, the Beeman, Sherwood, Oakland, Llewellyn, Bestman, and Eggert additions



ARCHITECTURAL/HISTORIC INVENTORY FORM

have been added to create what is presently known as the Forest-Llewellyn Cemetery. The newer additions are known as Forest Cemetery, located south of the Harrison Street entrance, and the Llewellyn Cemetery north of the Harrison Street entrance. The original Old City Cemetery "Kirkville Cemetery" is on the hill to the south and west of the Baird Vault.

After the expansions to the Cemetery, the Forest Cemetery Association was formed and incorporated in 1906. According to an article in *The Daily Express* on May 10, 1943, "up until 1906 the street leading to Forest Cemetery was in such a condition that in wet weather it was impossible to take horse-drawn vehicles farther than the Wabash Railway." The need for paved streets leading to the cemetery led to the formation of the Cemetery Improvement Association. Before the commission of the Cemetery Improvement Association, the cemeteries west of town were a mass of tangled weeds and tumbled tombstones. A number of fund raisers raised money for the upkeep of the Cemetery. Through the efforts of the women involved in this association, \$1000 was raised to renovate the Cemetery. These women received support in their efforts from nearly every man and woman in the city of Kirkville. Numerous charity events including a dinner and a Mother Hubbard ballgame put on by the men, raised enough money to make a \$1000 down payment on \$3000 worth of paved streets. Later, walks and drives were improved within the Cemetery as well. The women continued their fundraising events until they had paid for all of the improvements to the roads and walkways. Their attention turned to the care and beautification of the Cemetery. They straightened tombstones, cut weeds, planted grass seed and mowed it, placed flower beds in different parts, and employed a permanent caretaker. The women continued to raise money by holding a crossroads fair on the public square and a farmer's day. People who had moved away from the area expressed their appreciation by mailing contributions to the group. Work continued through the years, such as setting out shrubs and flowers, widening the driveway and putting in the turn-around drive through Forest Cemetery.

Work was done to bring the plots up to date in the 1940's, noting changes in lot ownership and removal of bodies to other cemeteries while war bonds were sold as part of a plan to provide permanent care in the future. In 1947, the City Council vacated the part of Harrison Street inside of the Cemetery at the request of the Cemetery Association. They created a new plot of the cemetery in 1956 and installed new water lines in 1957. In the years that followed, the trouble of maintenance and vandalism grew. In order to fight the growing problem of vandalism and maintenance upkeep, the Cemetery Association asked the city of Kirkville to assume responsibility for the Cemetery in 1962. The City declined. The Cemetery Association was reorganized again in 1974, but maintenance and organization remained a problem.

In February of 1975, the Association again appealed for the City Council of Kirkville to assume responsibility for the Cemetery. The City needed to establish ownership because deeds were not always recorded over the years and the Cemetery had grown haphazardly. They hired an abstractor and legal counsel to file a quiet title suit in order to establish legal bounds and ownership. The action was completed April 7, 1975 when Judge Bruce Normile established the City of Kirkville as the legal owner of all lands now called Forest-Llewellyn Cemetery.

The ordinance provided that \$20,000 held by the Cemetery Association was given to the City of Kirkville as an Endowment Fund. According to State Statutes, the money had to be invested and could not be used itself. Interest from this fund, approximately \$1,200 per year, was to help defray the cost of maintenance at the Cemetery. The City contracted maintenance and upkeep of the Cemetery over the years. In September of 1975, the City Council created a Cemetery Advisory Board and appointed four citizens and one council representative to it. The Board made several recommendations that the council approved regarding cost of lots, flowers removed from graves, fund-raising, stone setting, and spring cleanup by students.

The last 40 years have seen improvements for the Forest-Llewellyn Cemetery. The Cemetery Advisory Board was disbanded by the City Council in December of 1989. The duties of the Board were transferred to the Parks and Recreation Committee. In 1992, a portion of the Eggert Addition was marked with new lot markers and the map and records were updated. Lots are now available only from the Eggert Addition.

The records have been polished over the years by many different people. The first compilation of Cemetery records was printed in 1976. After additional records were added and corrected, an updated printing of the records was completed in 1983. Additional corrections have been noted as well as new burials in the Eggert Addition. Records have been computerized and updated again providing for placement on the City's web site. Some terms used in the 1800's have been changed to present day terminology, but most remain for historical purposes.

39 (cont.). Sources of information. Expand box as necessary, or add continuation pages.

1. Rich in Kirkville History, by Elizabeth Laughlin