



ARCHITECTURAL/HISTORIC INVENTORY FORM

1. Survey No. ADAS002-0001		2. Survey name: Kirksville Historic Properties Survey	
3. County: Adair		4. Address: 101 E. Burton	
5. City: Kirksville	Vicinity: <input type="checkbox"/>	6. UTM: 15/535473/4450543	7. Township/Range/Section: T: 62 R: 15 S: 4
8. Historic name (if known): Captain Thomas Harris House		9. Present/other name (if known): Parrish Place	
10. Ownership: <input checked="" type="checkbox"/> Private <input type="checkbox"/> Public		11. Historic use (if known): Residence	11. Current use: Residence

ARCHITECTURAL INFORMATION

12. Category of property: <input checked="" type="checkbox"/> building(s) <input type="checkbox"/> site <input type="checkbox"/> structure <input type="checkbox"/> object		19. Chimney placement: Side L&R, Rear Slope (6 total)	26. Changes (describe in box 28 cont.): <input type="checkbox"/> Addition(s) Date(s): <input type="checkbox"/> Altered Date(s): <input type="checkbox"/> Moved Date(s): <input type="checkbox"/> Other Date(s): Endangered by:
13. Architectural style or vernacular type: Italianate		20. Structural system: Brick	
14. Plan shape: Square		21. Ext. wall cladding: Brick	
15. No. of stories: 2		22. Foundation material: Stone	27. Outbuildings (describe in box 27 cont.): 1 Detached Garage, New in 2008 2 Small Portable Accessory Buildings, added in 2008.
16. No. of bays (1 st floor): 13		23. Basement type: Partial	
17. Roof type: Truncated Hip		24. Front porch type: None	
18. Roof material: Asphalt Shingles		25. Acreage (rural): Visible from public road? <input checked="" type="checkbox"/>	28. Further description of building features and associated resources on continuation page. <input checked="" type="checkbox"/>

HISTORICAL DATA

29. Construction date: 1875		32. Architect:	35. Previously surveyed? <input checked="" type="checkbox"/> Survey name: Northeast Missouri Regional Planning Commission - 1986
30. Significant date/period:		33. Builder/contractor: Thomas C. Harris	36. On National Register? <input checked="" type="checkbox"/> indiv. <input type="checkbox"/> district Nomination:
31. Area(s) of significance:		34. Original or significant owner: Thomas C. Harris	37. National Register eligible? <input type="checkbox"/> individually eligible <input type="checkbox"/> district potential
38. History and significance on continuation page. <input checked="" type="checkbox"/>		39. Sources of information on continuation page. <input checked="" type="checkbox"/>	

OTHER

40. Current owner/address: Daryl Shafer 101 E. Burton Kirksville, MO 63501		41. Form prepared by (name and org.): Brad Selby Kirksville Historic Preservation Comm. City of Kirksville	42. Survey date: March, 2009
			43. Date of revisions:

FOR SHPO USE:

Date entered in inventory:	Level of survey <input type="checkbox"/> reconnaissance <input type="checkbox"/> intensive	Additional research needed? <input type="checkbox"/> yes <input type="checkbox"/> no
National Register Status: <input type="checkbox"/> listed <input type="checkbox"/> in listed district Name: <input type="checkbox"/> pending listing <input type="checkbox"/> eligible (individually) <input type="checkbox"/> eligible (district) <input type="checkbox"/> not eligible <input type="checkbox"/> not determined	Other:	



ARCHITECTURAL/HISTORIC INVENTORY FORM

Location Map (include north arrow):

Site Map/plan (include north arrow):

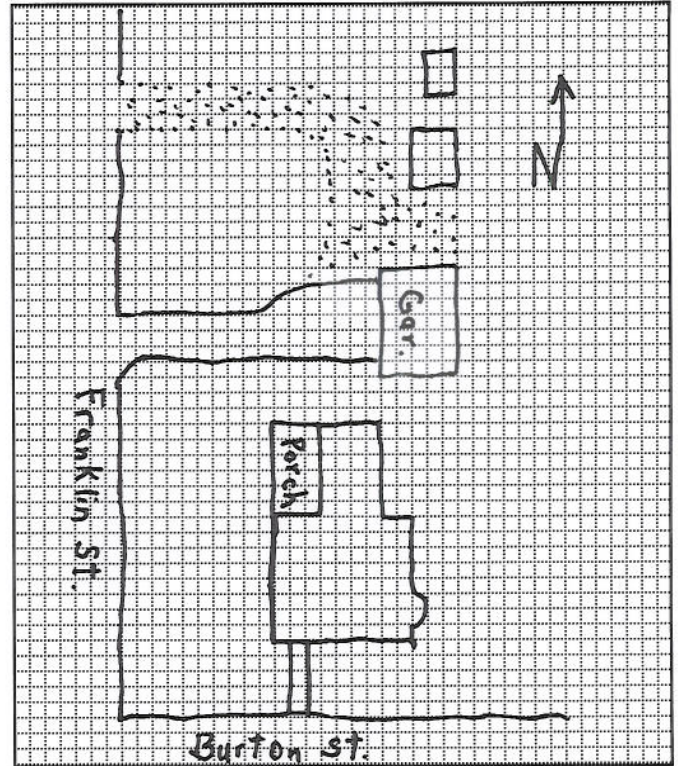
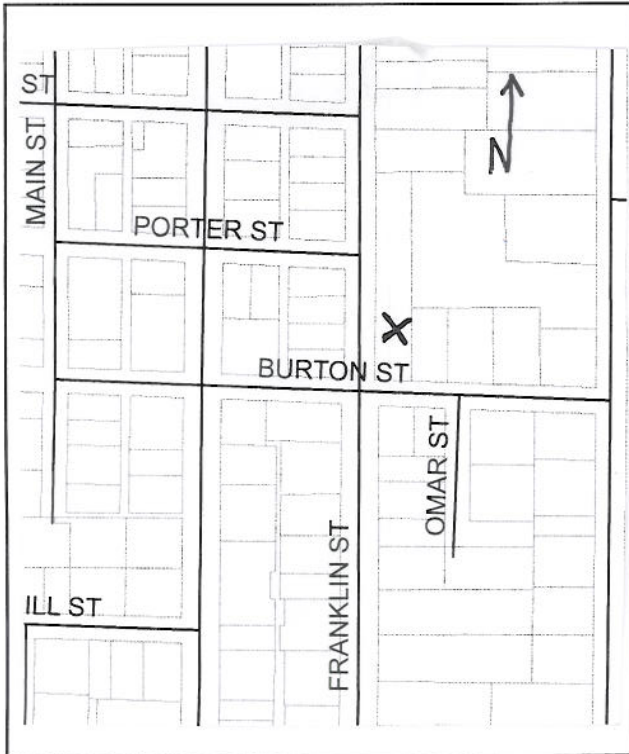

ADDITIONAL INFORMATION:

27. (cont.) Description of environment and outbuildings. Expand box as necessary, or add continuation pages.

The house and property were previously addressed as 1308 N. Franklin Street. In about 2006, the address was changed to 101 E. Burton Street. The house faces south. Behind it is a modern garage, added in 2008. Until 1958 the house retained it's summer kitchen, coal room and wood house. These were destroyed by fire. The house is situated on a very large corner lot. There are two small portable type accessory buildings in the rear (northern) part of the lot. These accessory buildings were added in 2007/2008.

28. (cont.) Further description of important architectural features. Expand box as necessary, or add continuation pages.

The house is a well detailed Italianate structure. It's front (south) facade is 3 ranked. The main entrance is located on the western most corner. It is a double leaf door, deeply set in a paneled jamb. It is topped by a rectangular transom with a rounded pane of glass. The door is surrounded by an ornate frame. It is flanked by chamfered pilasters, above which are elaborate brackets supporting a heavy cornice. The remainder of the bays on this elevation are elongated 2/2 windows with arched rowlock headers. The windows are fitted with wooded, louvered shutters. The west side of the house is two ranked with windows like those on the front. The east side of the house has a semi-hexagonal bay window. Above it is another window. To the north, a window is placed on each floor. The rear of the house is dominated by a large kitchen wing, original to the house, to which several additions have been made. The corners on the front of the structure each have stone quoins which are alternately diagonally or pebble grained. This continues up to a heavily molded wood entablature, which surrounds the house. Four sets of paired, scrolled brackets are equally spaced along each facade. Between these are molded, lozenge shaped panels. A cornice of dentils is set above these. The upper course of the entablature contains the house's gutter behind it's heavy molding. The house is topped by a truncated hip roof. Atop this is a replica of the original cupola, which was removed in 1965. The cupola has 2 arched windows on each elevation. The corners are decorated with heavily scrolled brackets.

The interior of the house has a large stair hall, a double parlor, kitchen and bathroom on its main floor. The main stair is of cherry and mahogany, and is paneled with turned balusters. The double parlors are joined by double, sliding doors. The front parlor has a 3-sided bay which contains its original shutters. Both have elaborate molding and brass picture rails. The upper story of the house has 3 bedrooms and a stair hall. Centrally located is a small stair which ascends to the cupola. The cupola has its original shutters. The kitchen wing also has a small stair which rises to an attic which was used as the servant's room.



ARCHITECTURAL/HISTORIC INVENTORY FORM

38. (cont.) History and significance. Expand box as necessary, or add continuation pages.

The house was constructed in 1875 for Captain Thomas C. Harris. He was a Union officer during the Civil War, settling in Kirksville to run a woolen mill in 1865. He sold the property in 1879 to Dr. John Burton. Dr. Burton was also a Civil War veteran, serving after the War's close as President of the United States Pension Board.

The structure was purchased in 1895 by Dr. Albert W. Parrish. He resided there with his family until 1928. One of his sons, Bert, became owner upon his death. The house passed to Mrs. Everella Murdock (nee Childers). Her parents were prominent in Sullivan County history, being instrumental in the publishing of that county's history in 1895. Mrs. Murdock deeded the house to her daughter, Mrs. Mary Childers Sloan, who passed away and left the property in the hands of the National Trust for Historic Preservation. They accepted the preservation of the property, and then sold it to Daryl Shafer in 2007, who completed a restoration of the house in 2008.

39 (cont.). Sources of information. Expand box as necessary, or add continuation pages.

**A Book of Adair County History, 1976, pages 297 and 298
National Trust for Historic Preservation - Ross Bradford
Northeast Missouri Regional Planning Commission survey, 1986**